

### ROOF FRAMING PLAN INSTRUCTIONS

A roof framing plan for a room addition is a plan to show clearly the location of new and existing roof framing and supports and bearing walls for the support of roof loads. Other requirements to be shown are:

1. Roof framing member sizes, location, and direction.
2. Location of purlins and bracing used.
3. Show connection of rafter ties for hip and ridge style roofs.
4. Plywood orientation, nailing and edge blocking where required.
5. Grade of framing and sheathing material used.
6. Show sections to show all critical and typical connections.
7. Call out members used to transfer seismic forces: dragties, collectors, shear transfer, strapping, and reinforcements.

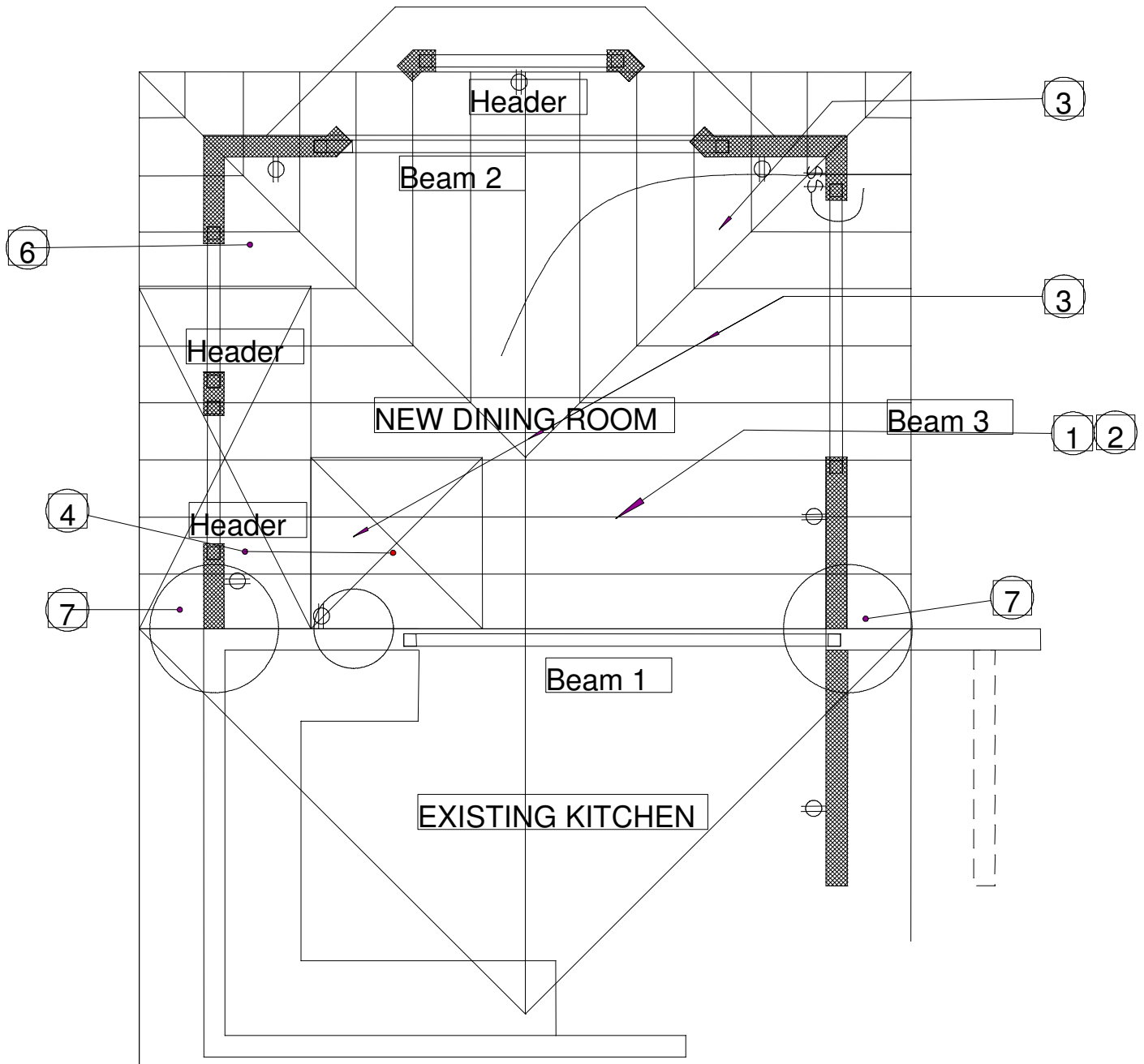

**SCALE** 1/4" = 1'