

DEPARTMENT OF PLANNING & BUILDING  
**EMERGENCY ESCAPE & RESCUE OPENING**  
**EXTERIOR COVERING WATER-RESISTIVE BARRIER**  
 (2010 CRC R310 & R703)

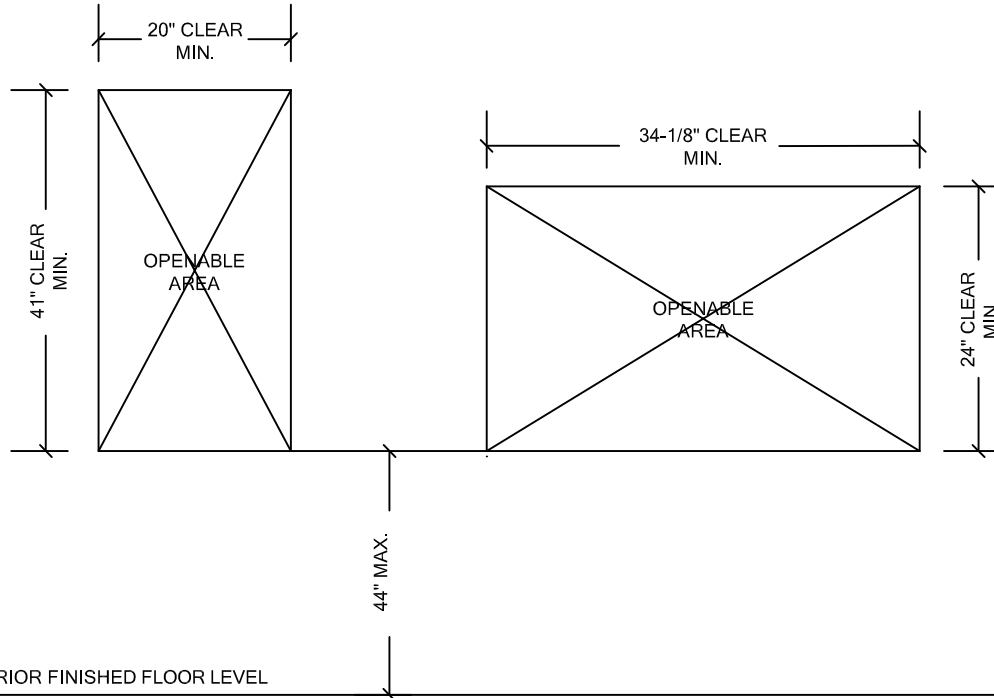

INTERIOR FINISHED FLOOR LEVEL

1. 20" MIN. CLEAR WIDTH
2. 24" MIN. CLEAR HEIGHT
3. 5.7 SF MIN. OPENABLE AREA  
 5.0 SF MIN. OPENABLE AREA  
 ON GRADE FLOOR PER  
 R310.1.1 EXCEPTION.

STANDARD 6'-8" HEADER HEIGHT

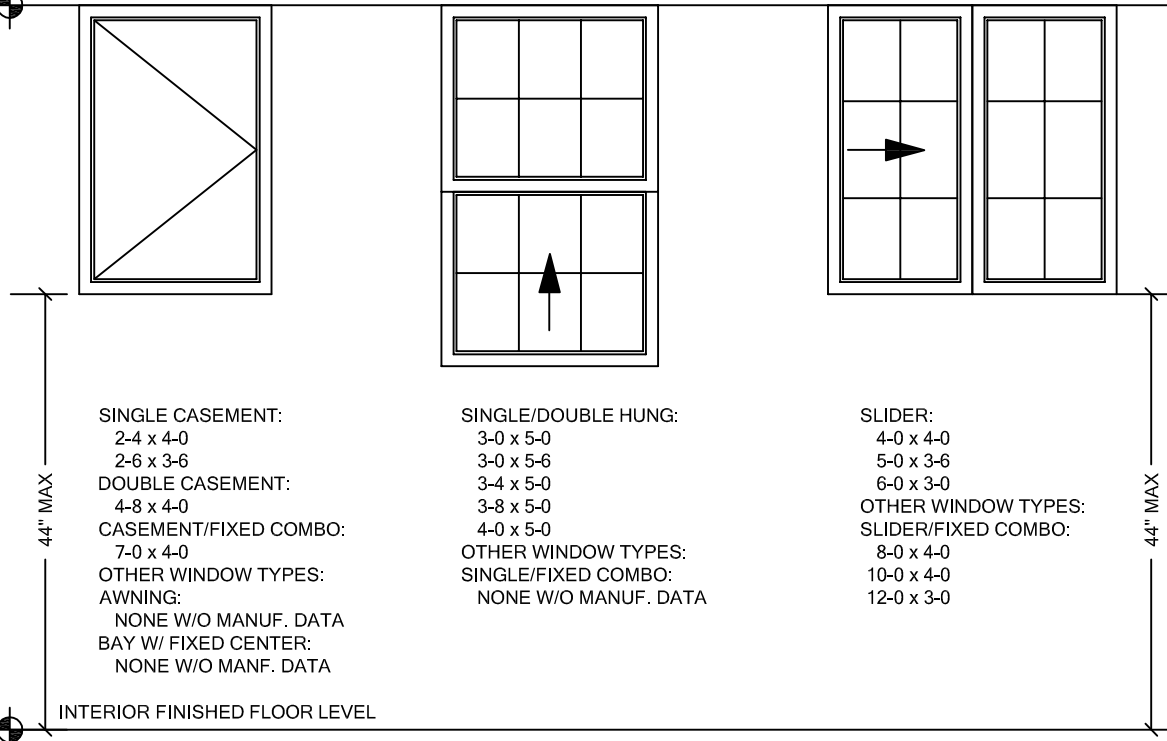

- SINGLE CASEMENT:  
 2-4 x 4-0  
 2-6 x 3-6  
 DOUBLE CASEMENT:  
 4-8 x 4-0  
 CASEMENT/FIXED COMBO:  
 7-0 x 4-0  
 OTHER WINDOW TYPES:  
 AWNING:  
 NONE W/O MANUF. DATA  
 BAY W/ FIXED CENTER:  
 NONE W/O MANF. DATA

- SINGLE/DOUBLE HUNG:  
 3-0 x 5-0  
 3-0 x 5-6  
 3-4 x 5-0  
 3-8 x 5-0  
 4-0 x 5-0  
 OTHER WINDOW TYPES:  
 SINGLE/FIXED COMBO:  
 NONE W/O MANUF. DATA

- SLIDER:  
 4-0 x 4-0  
 5-0 x 3-6  
 6-0 x 3-0  
 OTHER WINDOW TYPES:  
 SLIDER/FIXED COMBO:  
 8-0 x 4-0  
 10-0 x 4-0  
 12-0 x 3-0

INTERIOR FINISHED FLOOR LEVEL

**NOTE**  
 SIZES ARE TAKEN FROM DATA SUPPLIED BY WINDOW MANUFACTURERS, HOWEVER THESE ARE GENERAL DIMENSIONS. IT IS THE OWNERS RESPONSIBILITY TO VERIFY THAT THE ACTUAL WINDOWS INSTALLED MEET THE MINIMUM EGRESS REQUIREMENTS SET FORTH IN THE CALIFORNIA RESIDENTIAL CODE.

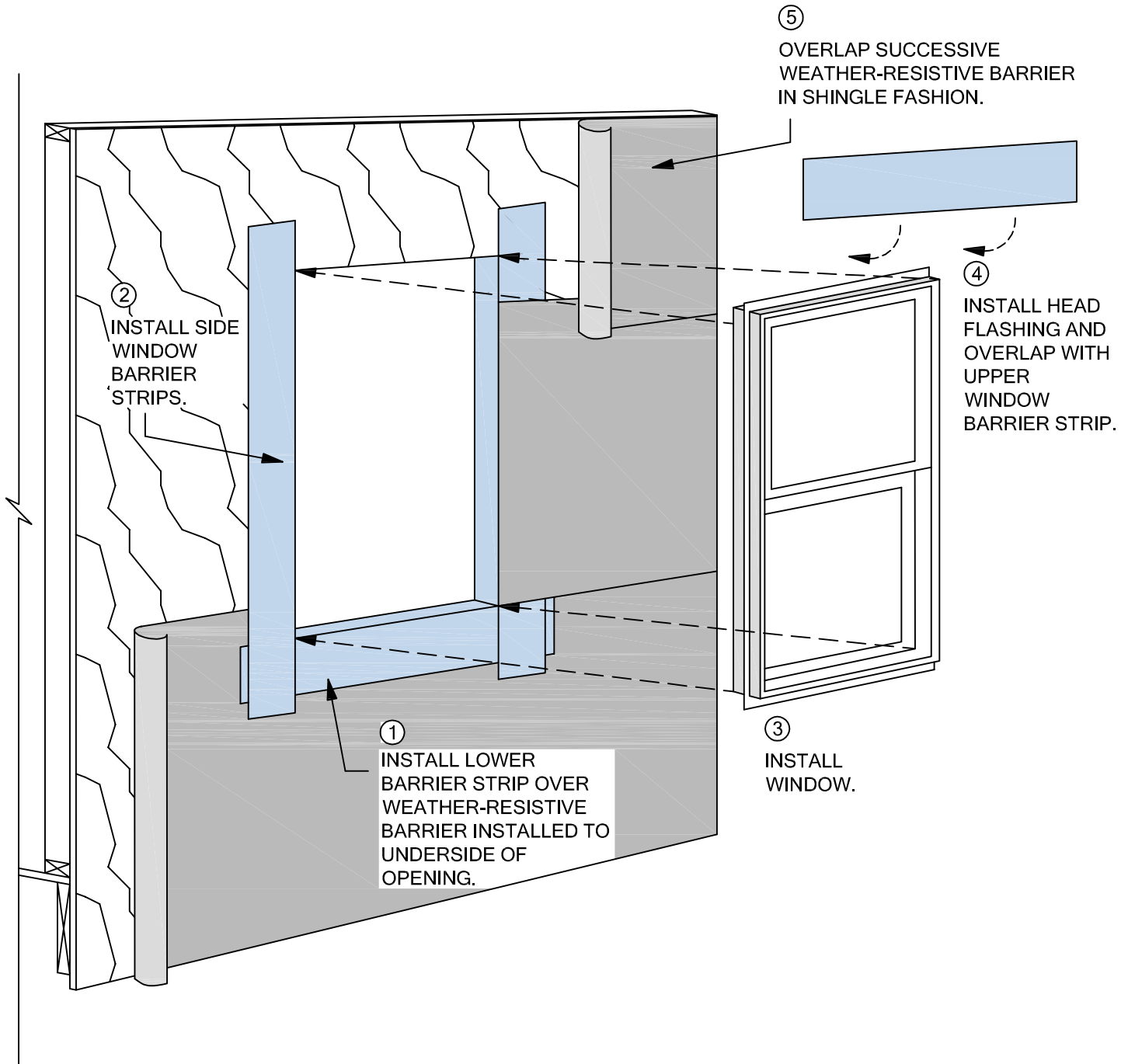

## TYPICAL FLASHING WINDOW OPENINGS

**NOTE**

WINDOW FLASHING DETAIL IS USED AS A GUIDELINE FOR TYPICAL WINDOW / DOOR INSTALLATIONS. IT IS THE OWNERS RESPONSIBILITY TO VERIFY THAT THE EXTERIOR COVERING INSTALLED MEET THE MINIMUM REQUIREMENTS OF THE CALIFORNIA RESIDENTIAL CODE AND PER MANUFACTURER'S SPECIFICATIONS / RECOMMENDATIONS.