

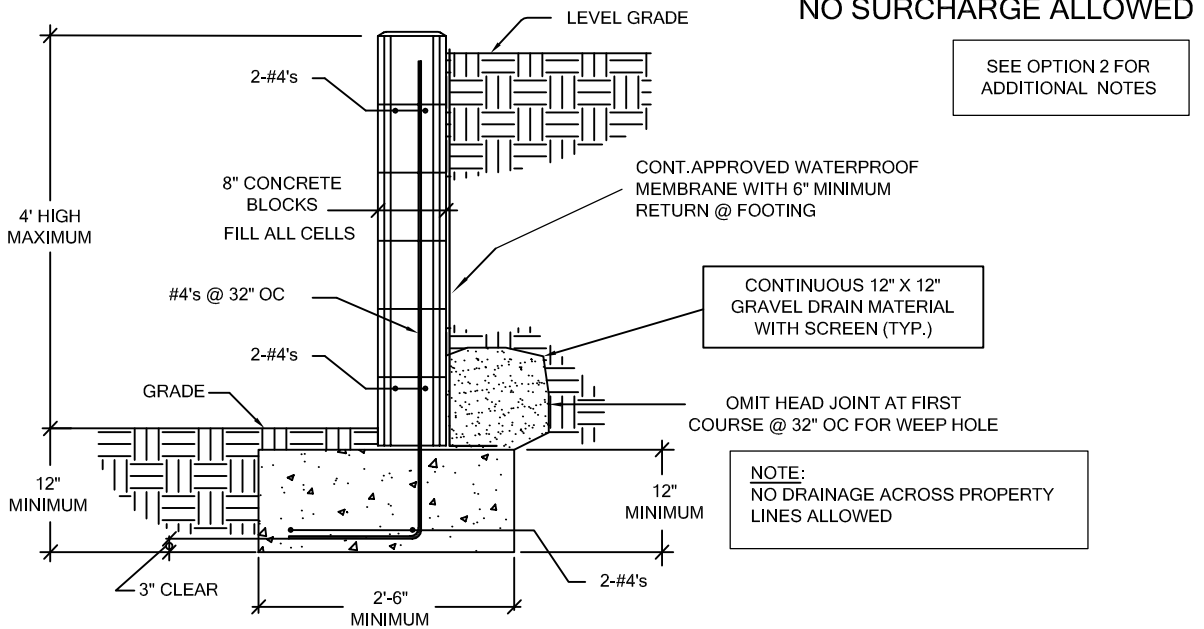

# CITY STANDARD PLAN 4'-0" HIGH MAX RETAINING WALL



NOTE -- ENGINEERING CALCULATION AND DETAILS REQUIRED FOR ALL RETAINING WALLS OTHER THAN SHOWN ON THIS SHEET.

## OPTION 1

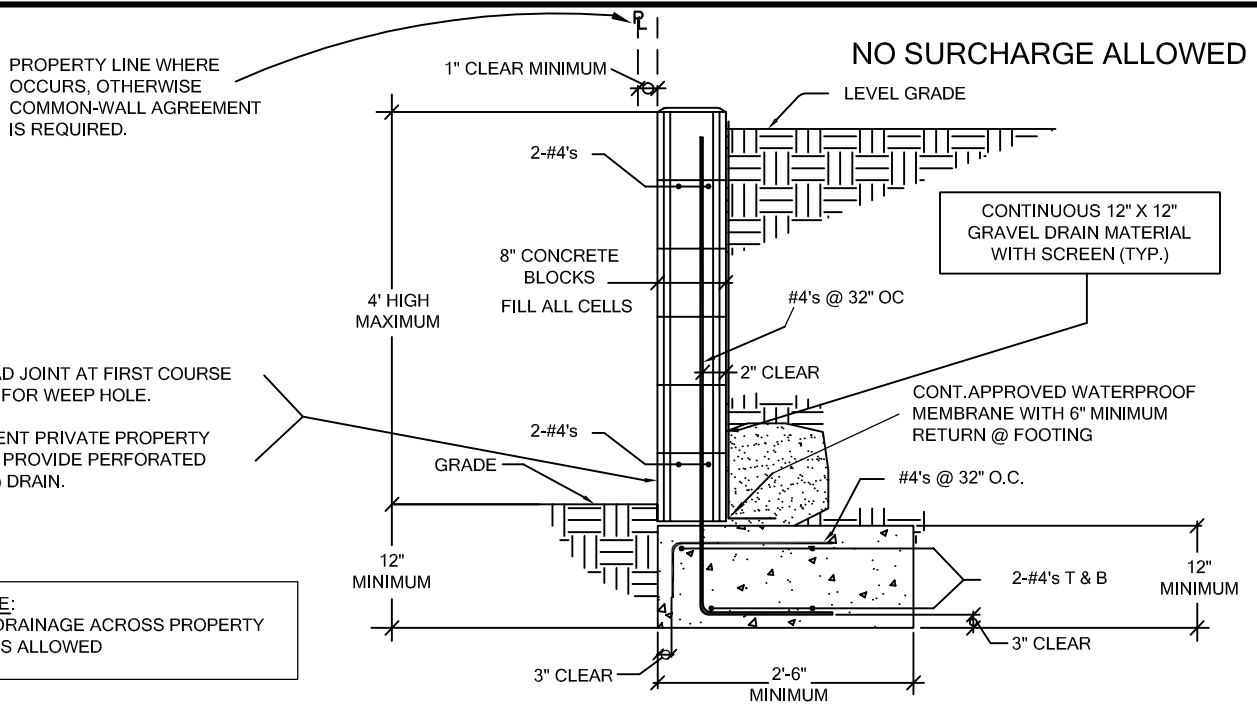

NOTE -- ENGINEERING CALCULATION AND DETAILS REQUIRED FOR ALL RETAINING WALLS OTHER THAN SHOWN ON THIS SHEET.

DESIGN FOR LEVEL GRADE ONLY AT TOP OF WALL (2007 CBC)

- CONCRETE STRENGTH 2,500 PSI MINIMUM AGE TESTED AT 28 DAYS.
- CONCRETE BLOCK - GRADE 'N' UNITS A.S.T.M. C-90
- GROUT - 1 PART CEMENT, 3 PARTS SAND, 2 PARTS PEA GRAVEL.
- MORTAR - 1 PART CEMENT, 1/2 PART LIME LUTTY (TYPE 'S'), 4 1/2 PART SAND.

## OPTION 2

**CITY STANDARD PLAN  
4'-0" HIGH MAXIMUM RETAINING WALL**GENERAL NOTES

1. ALL WORK SHALL CONFORM TO THE ADOPTED CODES AND ZONING REGULATIONS.
2. CONCRETE BLOCK MASONRY SHALL COMPLY WITH THE FOLLOWING:
  - CONCRETE STRENGTH 2500 PSI AGE TESTED @ 28 DAYS.
  - CONCRETE BLOCK - GRADE 'N' UNITS ASTM C-90.
  - GROUT - 1 PART CEMENT, 3 PARTS SAND, 2 PARTS PEA GRAVEL.
  - MORTAR - 1 PART CEMENT ½ PART LIME PUTTY (TYPE 'S'), 4½ PART SAND.
3. THE ULTIMATE COMPRESSIVE STRENGTH REQUIRED FOR FOUNDATION CONCRETE SHALL BE 2500 PSI.
4. ALL REINFORCING STEEL SHALL BE INTERMEDIATE GRADE ASTM A615-40 AND OVERLAP SPLICES SHALL BE 40 BAR DIAMETERS MINIMUM. ALL REBAR HOOKS SHALL BE A MINIMUM OF 12 TIMES THE REBAR DIAMETER (12bd) IN LENGTH.
5. PROVIDE RETAINING WALL DRAINAGE SYSTEM AS FOLLOWS:  
PROVIDE 1 CF/FT OF CLEAN COARSE GRAVEL WITH 4" DIAMETER PERFORATED PVC DRAINAGE PIPE WITH 1% GRADIENT TO DRAIN - OR OMIT HEAD JOINTS IN FIRST COURSE. NOTE: NO DRAINAGE ACROSS PROPERTY LINE (ADJACENT NEIGHBOR) ALLOWED.
6. OPTIONAL: INSTALLATION OF A MOISTURE BARRIER ON THE FILL SIDE OF THE WALL WILL HELP TO PREVENT MOISTURE FROM PENETRATING THE VISIBLE SIDE OF THE WALL, RESULTING IN DISCOLORATION.

REQUIRED INSPECTIONS

1. **FOOTING:** EXCAVATION TRENCH CLEAN WITH STEEL IN PLACE AND SUPPORTED 3" ABOVE AND AWAY FROM THE SURROUNDING EARTH / DIRT.
2. **REBAR / PRE-GROUT AND DRAINAGE SYSTEM :** BOND BEAM REBAR AND VERTICAL REBAR IN PLACE - INSPECTION PRIOR TO PLACING GROUT. DRAINAGE SYSTEM COMPLETE.
3. **FINAL INSPECTION:** AFTER GROUT IS PLACED AND BACKFILL IS COMPLETED - PRIOR TO ANY DECORATIVE CAP PLACEMENT.

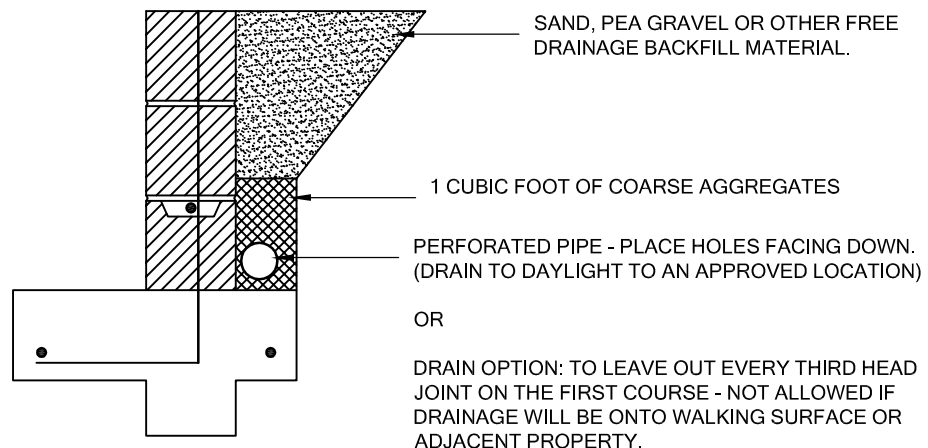

TYPICAL SECTION - (DRAINAGE DETAIL)  
PARTS OF THE RETAINING WALL ARE NOT SHOWN FOR CLARITY.